



# Technical Evaluation Report

TO ASSIST WITH CODE COMPLIANCE

**FastenMaster LedgerLOK™ Ledger Board Fasteners –  
Limit States**

**TER No. 1412-01**

**OMG, Inc.  
d/b/a/ FastenMaster**

**Issue Date: April 10, 2015  
Subject to Renewal: July 1, 2016**

153 Bowles Road  
Agawam, Massachusetts 01001  
413-789-0252  
[fastenmaster.com](http://fastenmaster.com)

**DIVISION: 06 00 00 – WOOD, PLASTICS, AND COMPOSITES**

Section: 06 05 23 – Wood, Plastic, and Composite Fastenings

Section: 06 11 00 – Wood Framing

Section: 06 15 00 – Wood Decking

**1. Products Evaluated:**

- 1.1. LedgerLOK™ Ledger Board Fasteners
- 1.2. For the most recent version of this report, visit [drjengineering.org](http://drjengineering.org). For more detailed state professional engineering and code compliance legal requirements and references, visit [drjengineering.org/statelaw](http://drjengineering.org/statelaw). DrJ is fully compliant with all state professional engineering and code compliance laws.

**2. Applicable Codes and Standards:<sup>1</sup>**

- 2.1. *National Building Code of Canada (NBC), 2010*
- 2.2. *CSA 086 – Engineering Design in Wood, 2009*

**3. Performance Evaluation:**

- 3.1. LedgerLOK Ledger Board Fasteners were evaluated to determine their ability to provide code complying attachment of deck ledger boards to the building structure.
- 3.2. LedgerLOK Ledger Board Fasteners were evaluated for lateral resistance and withdrawal resistance, in accordance with CSA 086 Clause 10.11.4 and 10.11.5.

<sup>1</sup> Unless otherwise noted, all references in this TER are from the 2010 version of the NBC and the standards referenced therein, including, but not limited to, CSA 086-09.

**DrJ is a Professional Engineering Approved Source**

 **Learn more about DrJ's Accreditation**

- DrJ is an ISO/IEC 17065 accredited product certification body through ANSI Accreditation Services.
- DrJ provides certified evaluations that are signed and sealed by a P.E.
- DrJ's work is backed up by professional liability insurance.
- DrJ is fully compliant with IBC Section 1703.



## Technical Evaluation Report (TER)

3.2.1. Where a band joist is not used, as in some truss installations, an engineered design is required.

3.3. Any code compliance issues not specifically addressed in this section are outside the scope of this evaluation.

### 4. Product Description and Materials:

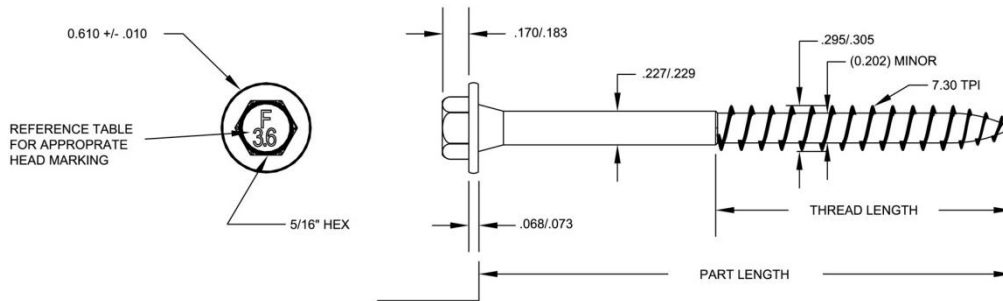

**Figure 1:** LedgerLOK Ledger Board Fasteners (in.)

- 4.1. LedgerLOK fasteners are manufactured with carbon steel grade 1022 or 10B21 wire conforming to *ASTM A510* with a minimum ultimate tensile strength of 60 ksi.
- 4.2. LedgerLOK fasteners are manufactured using a standard cold-formed process followed by a heat-treating process. Critical dimensions, design values for lumber species and allowable bending yield are found in [Figure 1](#), [Table 1](#) and [Table 2](#).
  - 4.2.1. LedgerLOK fastener heads are a  $\frac{5}{16}$ " hex drive with a built-in oversized washer.
  - 4.2.2. LedgerLOK fasteners have a gimlet point.
  - 4.2.3. The LedgerLOK fasteners listed in [Table 1](#) were evaluated for this Technical Evaluation Report (TER).

Fastener Name	Fastener Designation	Head Marking	Length <sup>1</sup> in. (mm)	Length of Thread <sup>2</sup> in. (mm)	Unthreaded Shank Diameter in. (mm)	Minor Thread (Root) Diameter in. (mm)	Nominal Bending Yield psi <sup>3</sup> (Mpa)
LedgerLOK	FMLL358	F3.6	3.63 (92)	2.00 (50)	0.227 (5.8)	0.202 (5.1)	200,700 (1384)
LedgerLOK	FMLL005	F5.0	5.00 (127)	3.00 (76)			

For SI: 1" = 25.4 mm, 1 psi = .00689 Mpa  
 1. Measured from the underside of the head to the bottom of the tip.  
 2. Includes tip; see [Figure 1](#).  
 3. Determined in accordance with methods specified in *ASTM F1575*, based on minor thread diameter using a 5% offset of the load displacement curves developed from the average of bending tests. Nominal bending yield based of the shank diameter using the same method is 186,790 psi (1290 Mpa).

**Table 1:** Fastener Designation for the LedgerLOK Fasteners Evaluated in this TER

- 4.3. Factored lateral strength and withdrawal resistance values for LedgerLOK Ledger Board Fasteners are given in [Table 2](#).

Property	Northern Species (G = 0.35)	Spruce-Pine-Fir (G = 0.42)	Hem Fir (G = 0.46)	Douglas Fir (G = 0.49)
Factored Withdrawal Resistance Values <sup>1</sup> lb./in. (N/mm)	285 (50)	388 (68)	439 (77)	485 (85)
Factored Lateral Strength Resistance <sup>2</sup> lb. (N)	192 (855)	243 (1080)	272 (1210)	295 (1310)

For SI: 1 lb./in. = 0.1751 N/mm, 1 lb. = 4.4482 N  
 1. A phi factor ( $\Phi$ ) of 0.6 has been applied to the Factored Withdrawal Resistance Values. All other applicable factors shall be applied in accordance with *CSA O86* Clause 10.11.5.  
 2. A phi factor ( $\Phi$ ) of 0.8 and a wet service factor ( $K_{SF}$ ) of 0.67 have been applied to the Factored Withdrawal Resistance Values. All other applicable factors shall be applied in accordance with *CSA O86* Clause 10.11.4.

**Table 2:** Design Values for Lumber Species Groups for LedgerLOK Fasteners

## Technical Evaluation Report (TER)

- 4.4. The fasteners have a proprietary galvanized and epoxy coating, which provides corrosion protection that exceeds that provided by code approved hot-dipped galvanized coatings meeting *ASTM A153*.
- 4.4.1. Fasteners are approved for use in exterior conditions and in pressure-treated wood, including ground contact ACQ. Treatments other than ACQ that are found to be less corrosive than ACQ are also approved.
- 4.5. Fasteners are approved for use in fire-retardant-treated lumber, provided the conditions set forth by the fire-retardant-treated lumber manufacturer are met, including appropriate strength reductions.
- 4.6. In-plant quality control procedures, under which the LedgerLOK fasteners are manufactured, are audited through an inspection process performed by an approved agency.

### 5. Applications:

- 5.1. LedgerLOK Ledger Board Fasteners are designed specifically for attaching the deck ledger to the rim joist of a building in accordance with the *NBC*, 2010 edition, Section 9.4.2.3.

- 5.1.1. Deck live load = 40, 60, 80 psf, plus deck dead load = 10 psf (0.48 kPa) is shown in [Table 3](#).

Loading Condition (Live Load, kPa)	2x Nominal Ledger Species	Maximum Deck Joist Spans (m)							
		Meters							
		Up to 2	2.5	3	3.5	4	4.5	5	5.5
		Feet							
		Up to 6.5	8	10	11.5	13	14.5	16.5	18
Maximum On-Center Spacing of LedgerLOK Ledger Board Fasteners in. (mm)									
40 psf (1.91 kPa)	Northern Species	11 (275)	8 (225)	7 (175)	6 (150)	5 (125)	5 (125)	4 (100)	4 (100)
	Spruce-Pine-Fir	13 (350)	11 (275)	9 (225)	8 (200)	7 (175)	6 (150)	5 (125)	5 (125)
	Hem Fir	15 (375)	12 (300)	10 (250)	9 (225)	7 (200)	7 (175)	6 (150)	5 (150)
	Douglas Fir	16 (400)	13 (325)	11 (275)	9 (225)	8 (200)	7 (175)	6 (175)	6 (150)
60 psf (2.87 kPa)	Northern Species	8 (200)	6 (150)	5 (125)	4 (100)	4 (100)	3 (75)	3 (75)	3 (75)
	Spruce-Pine-Fir	9 (250)	8 (200)	6 (150)	5 (150)	5 (125)	4 (100)	4 (100)	3 (100)
	Hem Fir	11 (275)	9 (225)	7 (175)	6 (150)	5 (125)	5 (125)	4 (100)	4 (100)
	Douglas Fir	12 (300)	9 (225)	8 (200)	7 (175)	6 (150)	5 (125)	5 (125)	4 (100)
80 psf (3.83 kPa)	Northern Species	6 (150)	5 (125)	4 (100)	3 (75)	3 (75)	3 (75)	2 (50)	2 (50)
	Spruce-Pine-Fir	7 (200)	6 (150)	5 (125)	4 (100)	4 (100)	3 (75)	3(75)	3 (75)
	Hem Fir	8 (200)	7 (175)	6 (150)	5 (125)	4 (100)	4 (100)	3 (75)	3 (75)
	Douglas Fir	9 (225)	7 (175)	6 (150)	5 (125)	4 (125)	4 (100)	4 (100)	3 (75)

For SI: 1" = 25.4 mm

1. Based on load duration of 1.0. Spacing may be adjusted by the applicable load duration as specified in *CSA O86-09*.
2. Fasteners are required to have full thread penetration into the OSB and main member. Excess fastener length extending beyond the main member is not reflected in the table above.
3. Solid sawn band joists shall be HF, SPF, DF-L or Northern species, designed by others. For engineered wood band joists having a specific gravity of 0.5 and a minimum thickness of 1<sup>1</sup>/<sub>8</sub>", on-center spacing for Douglas Fir may be used.
4. Spacing is based on non-incised lumber. Where incised lumber is used, reduce spacing requirements by 15%.
5. Table values assume 10 psf (0.48 kPa) dead load.
6. The service condition factor,  $K_{SF} = 0.67$  has been applied.
7. Sheathing shall be minimum 11-mm-thick OSB (SG=0.5) or other sheathing with a specific gravity at equal to the specific gravity of the band joist material.

**Table 3:** LedgerLOK Fastener Spacing – Materials & Loading Conditions

## Technical Evaluation Report (TER)

### 6. Installation:

- 6.1. Choose a 3.63" (92 mm) or 5" (127 mm) LedgerLOK Ledger Board Fastener, so that the threads fully engage the band joist material and the fastener tip extends beyond the back face of the band joist material when fully seated against the installed ledger.
- 6.2. Using a high-torque, ½" variable-speed drill (18V, if cordless), drive the fasteners through the ledger and sheathing. Continue into the rim joist until the built-in washer head is drawn firm and flush to the ledger board. Do not overdrive.
- 6.3. [Figure 2](#) shows a detail of the LedgerLOK Ledger Board Fastener deck connection, including minimum edge and end distances.

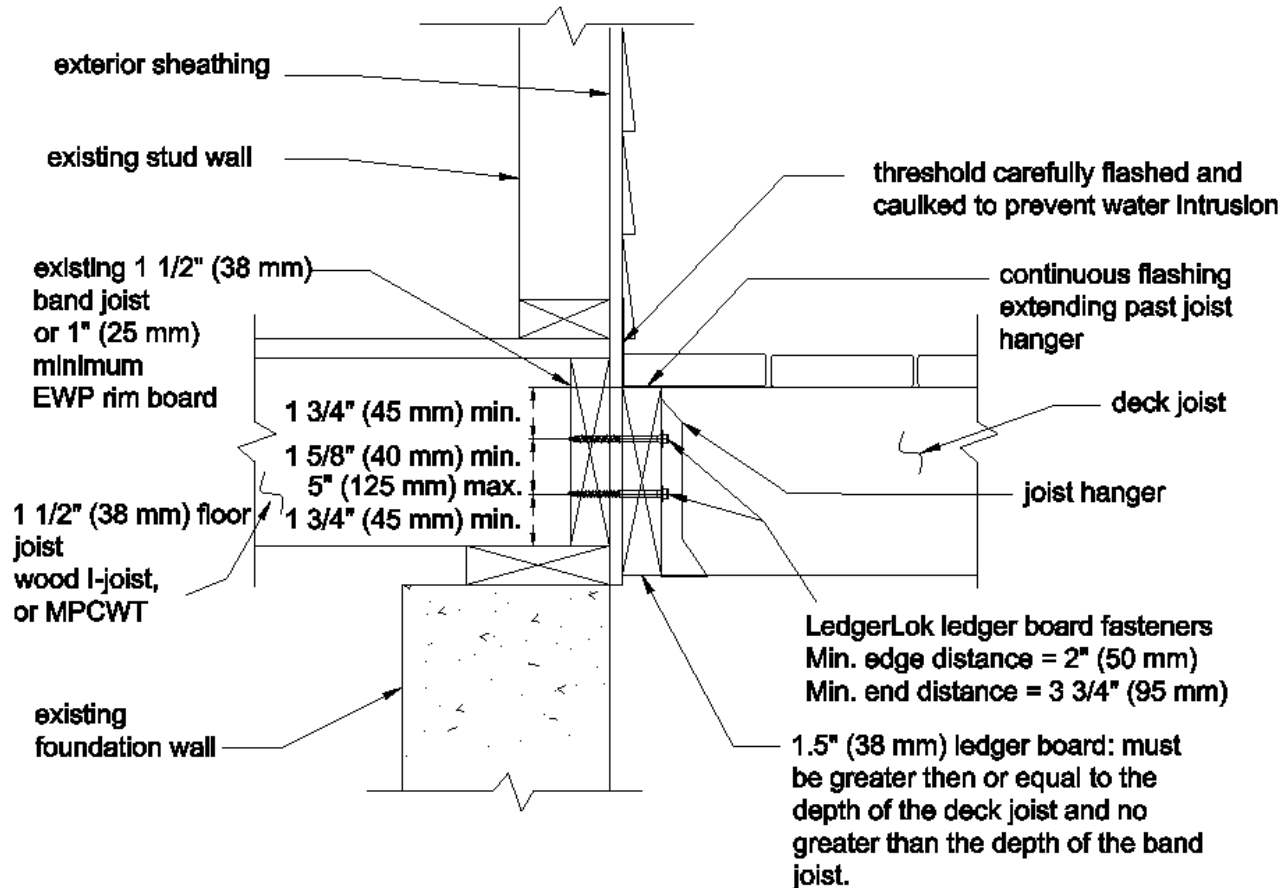

Figure 2: LedgerLOK Ledger Board Fastener Deck Connection

- 6.4. For applications outside the scope of this TER, an engineered design is required.

### 7. Test and Engineering Substantiating Data:

- 7.1. The product(s) evaluated by this TER falls within the scope of one or more of the model, state or local building codes for building construction. The testing and/or substantiating data used in this TER is limited to buildings, structures, building elements, construction materials and civil engineering related specifically to buildings.
- 7.2. The provisions of model, state or local building codes for building construction do not intend to prevent the installation of any material or to prohibit any design or method of construction. Alternatives shall use consensus standards, performance-based design methods or other engineered alternative means of compliance. This TER assesses compliance with defined standards, generally accepted engineering analysis, performance-based design methods, etc. in the context of the pertinent building code requirements.
- 7.3. Testing analysis for derivation of design properties for FastenMaster LOK® Screws, Wood Science and Technology Centre at the University of New Brunswick, 2009.
- 7.4. Testing conducted by Washington State University for OMG; Final report date: August 4, 2005.

## Technical Evaluation Report (TER)

- 7.5. Testing conducted by the University of Montana Wood Science Laboratory for OMG, 2004.
- 7.6. *CSA/CAN 086-09 – Engineering Design in Wood*; Canadian Standards Association; Toronto, ON.
- 7.7. Some information contained herein is the result of testing and/or data analysis by other sources, which DrJ relies on to be accurate as it undertakes its engineering analysis.
- 7.8. DrJ has reviewed and found the data provided by other professional sources are credible. This information has been approved in accordance with DrJ's procedure for acceptance of data from approved sources.
- 7.9. DrJ's responsibility for data provided by approved sources is in accordance with professional engineering law.
- 7.10. Where appropriate, DrJ relies on the derivation of design values, which have been codified into law through codes and standards (e.g., *IRC*, *WFCM*, *IBC*, *SDPWS*, etc.). This includes review of code provisions and any related test data that helps with comparative analysis or provides support for equivalency to an intended end-use application.

### 8. Findings:

- 8.1. When used in accordance with this TER and the manufacturer's installation instructions, FastenMaster LedgerLOK Ledger Board Fasteners meet the requirements of *NBC* Section 9.4.2.3 for deck ledger attachments.
- 8.2. Testing and analysis of the LedgerLOK Ledger Board Fasteners are in accordance with the requirements of *CSA 086-09*.

### 9. Conditions of Use:

- 9.1. Where required by the authority having jurisdiction (AHJ) in which the project is to be constructed, this report and the installation instructions shall be submitted at the time of permit application.
- 9.2. Any generally accepted engineering calculations needed to show compliance with this TER shall be submitted to the code official for review and approval.
- 9.3. Design loads shall be determined in accordance with the building code adopted by the jurisdiction in which the project is to be constructed.
- 9.4. LedgerLOK fasteners covered by this TER shall be installed in accordance with this report and the manufacturer's installation instructions.
- 9.5. LedgerLOK fastener spacing shall not exceed [Table 3](#) for code compliance and the installation conditions considered.
- 9.6. For conditions not covered in this TER, connections shall be designed in accordance with generally accepted engineering practice.
- 1.1. The manufacturer's installation instructions shall be followed as provided in [Section 6](#) and at [fastenmaster.com/details/product/ledgerlok-ledger-board-fastener.html](http://fastenmaster.com/details/product/ledgerlok-ledger-board-fastener.html).
- 9.7. LedgerLOK fasteners are produced by OMG, Inc.'s facility located in Agawam, Massachusetts.
- 9.8. LedgerLOK fasteners are produced under a quality control program subject to periodic inspections.
- 9.9. Design
  - 9.9.1. Building Designer Responsibility
    - 9.9.1.1. Unless the AHJ allows otherwise, the Construction Documents shall be prepared by a Building Designer (e.g., Owner, Registered Design Professional, etc.) for the Building and shall be in accordance with [IRC Section R106](#) and [IBC Section 107](#).
    - 9.9.1.2. The Construction Documents shall be accurate and reliable and shall provide the location, direction and magnitude of all applied loads and shall be in accordance with [IRC Section 301](#) and [IBC Section 1603](#).
  - 9.9.2. Construction Documents
    - 9.9.2.1. Construction Documents shall be submitted to the Building Official for approval and shall contain the plans, specifications and details needed for the Building Official to approve such documents.

## Technical Evaluation Report (TER)

### 9.10. Responsibilities

- 9.10.1. The information contained herein is a product, engineering or building code compliance research report performed in accordance with the referenced building codes, testing and/or analysis through the use of accepted engineering procedures, experience and good technical judgment.
- 9.10.2. DrJ research reports provide an assessment of only those attributes specifically addressed in the Products Evaluated or Code Compliance Process Evaluated section.
- 9.10.3. The engineering evaluation was performed on the dates provided in this TER, within DrJ's professional scope of work.
- 9.10.4. This product is manufactured under a third-party quality control program in accordance with [IRC Section R104.4](#) and [R109.2](#) and [IBC Section 104.4](#) and [110.4](#).
- 9.10.5. The actual design, suitability and use of this research report for any particular building is the responsibility of the Owner or the Owner's authorized agent, and the report shall be reviewed for code compliance by the Building Official.
- 9.10.6. The use of this TER is dependent on the manufacturer's in-plant QC, the ISO/IEC 17020 third-party inspection process, proper installation per the manufacturer's instructions, the Building Official's inspection and any other code requirements that may apply to assure accurate compliance with the applicable building code.

### 10. Identification:

- 10.1. The fasteners are identified by the designation "LedgerLOK™" on the packaging. The head of each fastener is marked with an "F" followed by a number corresponding to the length of the fastener.
- 10.2. The packaging shall include OMG's name and address, fastener size, third-party inspection agency, and TER number.
- 10.3. Additional technical information can be found at [fastenmaster.com](http://fastenmaster.com).

### 11. Review Schedule:

- 11.1. This TER is subject to periodic review and revision. For the most recent version of this report, visit [drjengineering.org](http://drjengineering.org).
- 11.2. For information on the current status of this report, contact [DrJ Engineering](#).



- [Mission and Professional Responsibilities](#)
- [Product Evaluation Policies](#)
- [Product Approval – Building Code, Administrative Law and P.E. Law](#)